



Icezone Installation Instructions for Follett Horizon Chewblet Ice Machines

Please review the entire instructions prior to installation.



INFORMATION

Follow the manufacturers guidelines for cleaning the ice and water dispenser thoroughly.

Before Installing Icezone, clean and sanitize the interior of the ice and water dispenser thoroughly according to the manufacturer's guidelines. All surfaces should be free of slime and scale before starting the installation.



RECOMMENDED TOOLS

- Sharpie or other brand marker
- Hand Drill
- Phillips Bit Driver
- 7/8" Step Drill Bit
- 1/4" Nut Driver
- Phillips Screwdriver
- 4ft Ladder
- Safety Goggles
- Hose Cutter or Utility Knife
- 1 1/4" Crescent Wrench
- Marker to mark hole locations
- File or knife to de-burr holes

INSTALLATION OVERVIEW

This is a Follett Horizon Chewblet ice machine in place beside a Cornelius drink dispenser in a typical restaurant installation.

Follett ice machine model HCC1400A shown to the left of Cornelius drink dispenser model IDC255

Before installing Icezone, the ice machine and the drink dispenser should both be powered off.



Note where IceZone will be installed on top of the Cornelius IDC255 drink dispenser.

Supply Line and Return Line are indicated from top view with top panel in place.

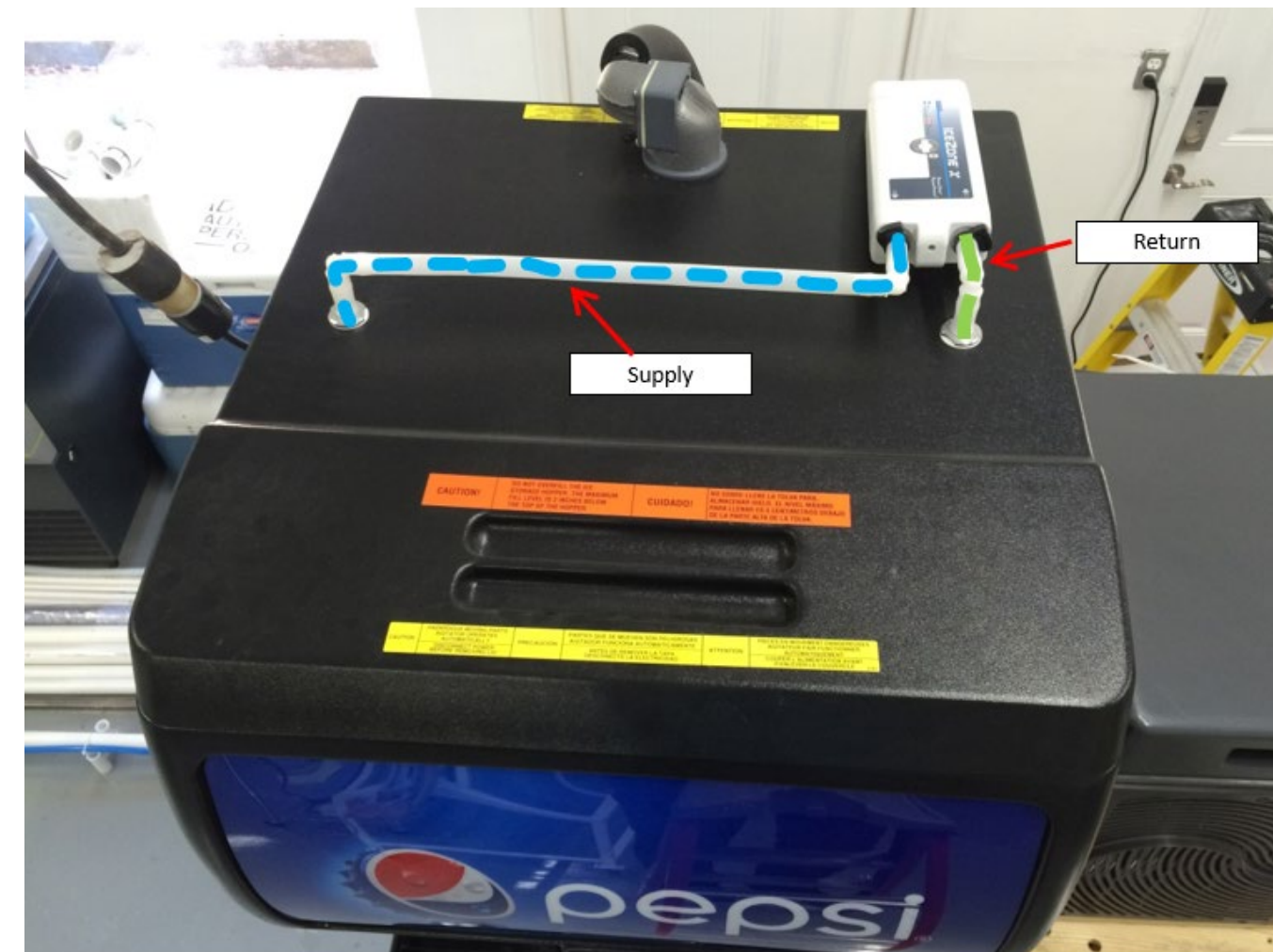

ICEZONE INSTALLATION

Supply Line and Return Line are indicated from bottom view with top panel opened.

Note that the Follett ice transport bulkhead fitting is noted for reference only and is not used in the installation of IceZone.

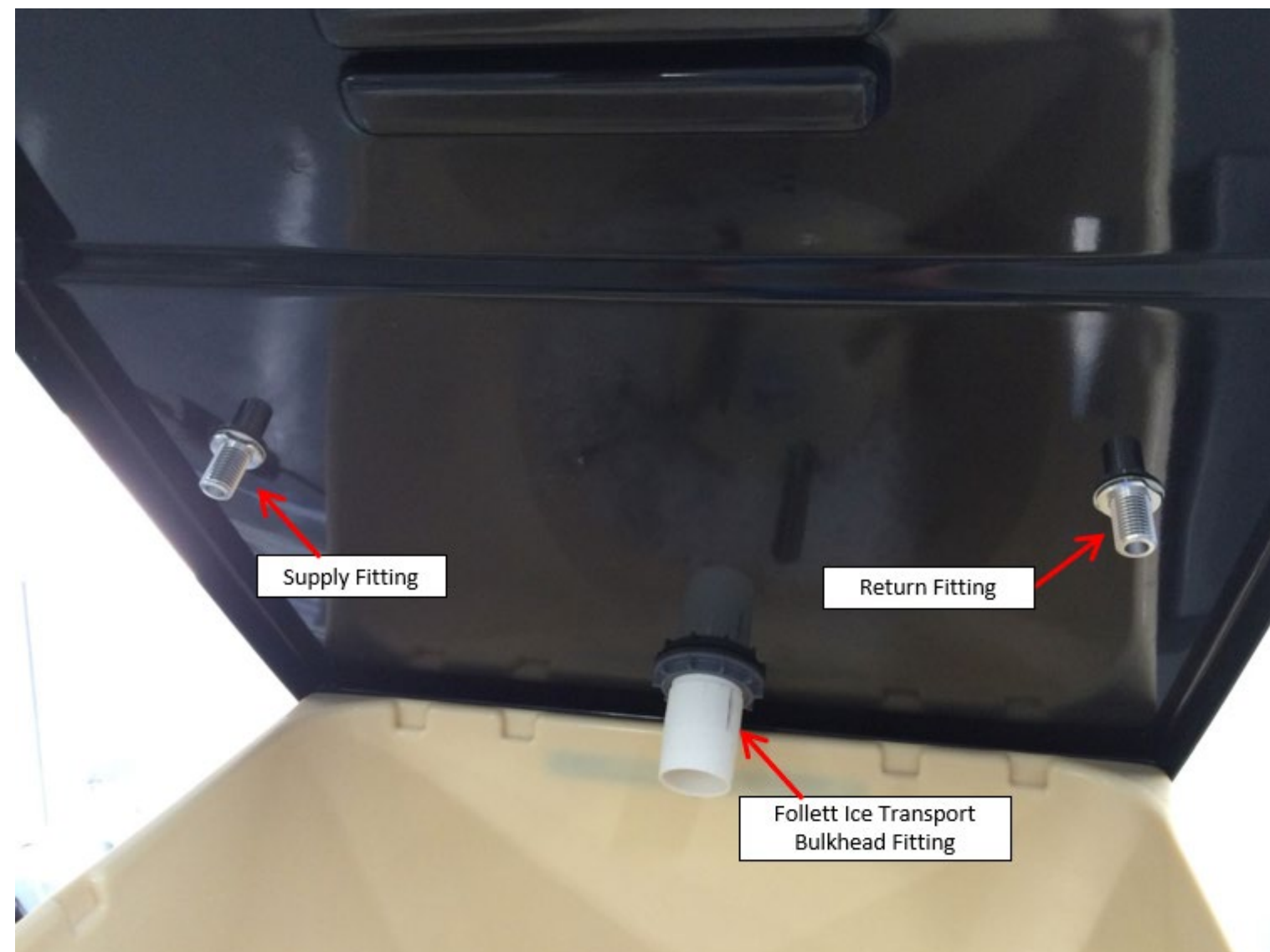

Mark the location for the Icezone Supply and Return fittings. These should be located on either side of the top panel/cover. These holes should be spaced from the side of the top panel/cover by 4 inches. These holes should be spaced from the back of the top panel/cover by 14.5 inches also.

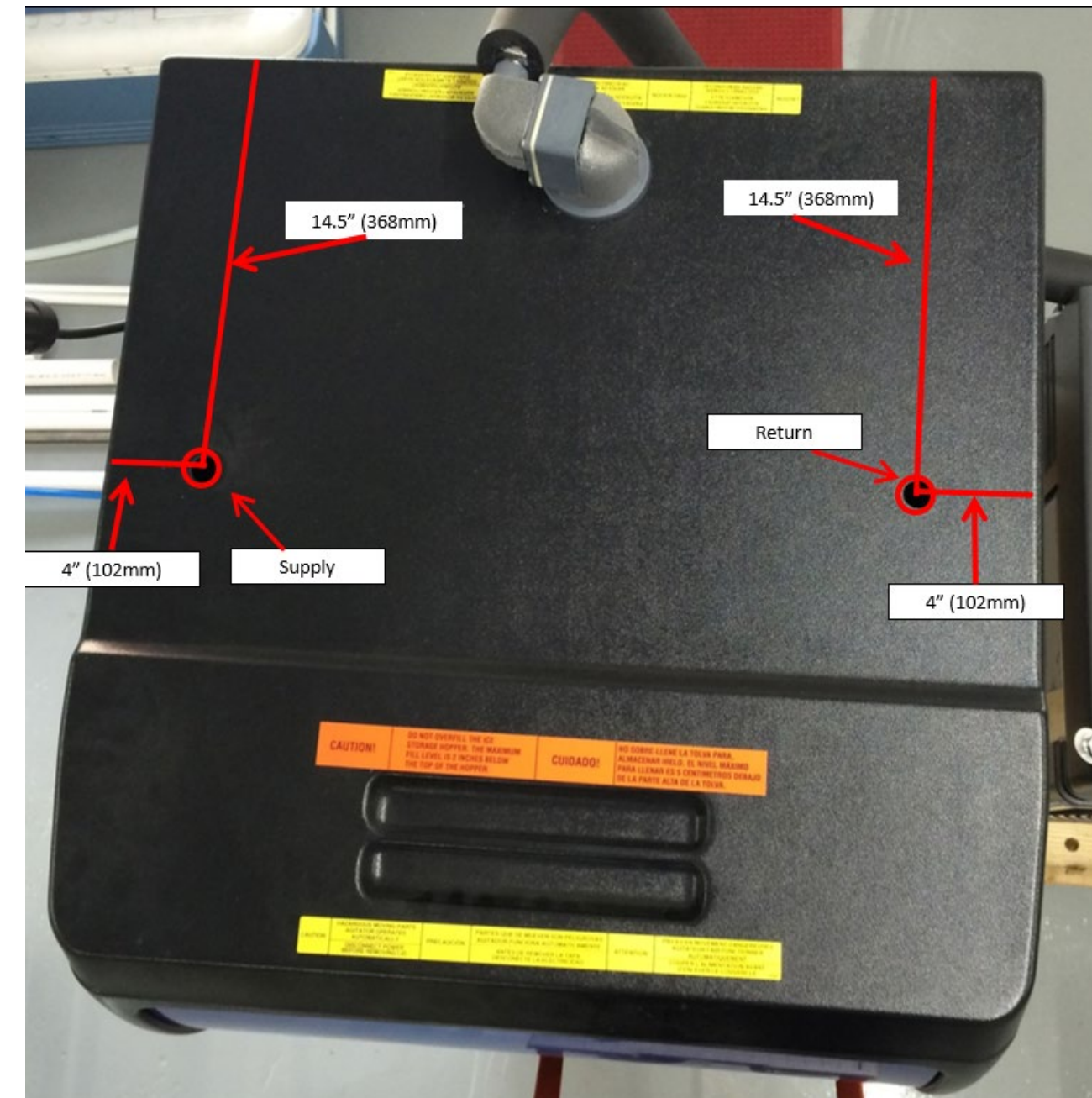

ICEZONE INSTALLATION

Assemble the Supply and Return fittings as shown.

This includes a single ended barb fitting, low profile nut and white rubber washer.

Insert the threaded fitting into the hole from the top of the top panel/cover.



Install the Supply and Return fittings as shown.

This includes a second low profile nut and white rubber washer that are fitted from the bottom of the top panel/cover.



ICEZONE INSTALLATION

Place Icezone on the lid and layout the routing of the supply and return tubing.

In this installation pictured, Icezone is placed near the back right corner of the cover (*looking at the front of the ice machine*).

Place 3 of the 90 degree hose barbs in place to visualize the routing. Observe the flow direction arrows on Icezone indicating Supply and Return.

Mark the holes to mount the Icezone Unit on the lid.

Use a pen to locate the three mounting holes.



ICEZONE INSTALLATION

Drill the holes to mount the Icezone Unit on the lid.

Drill three 1/8" holes.

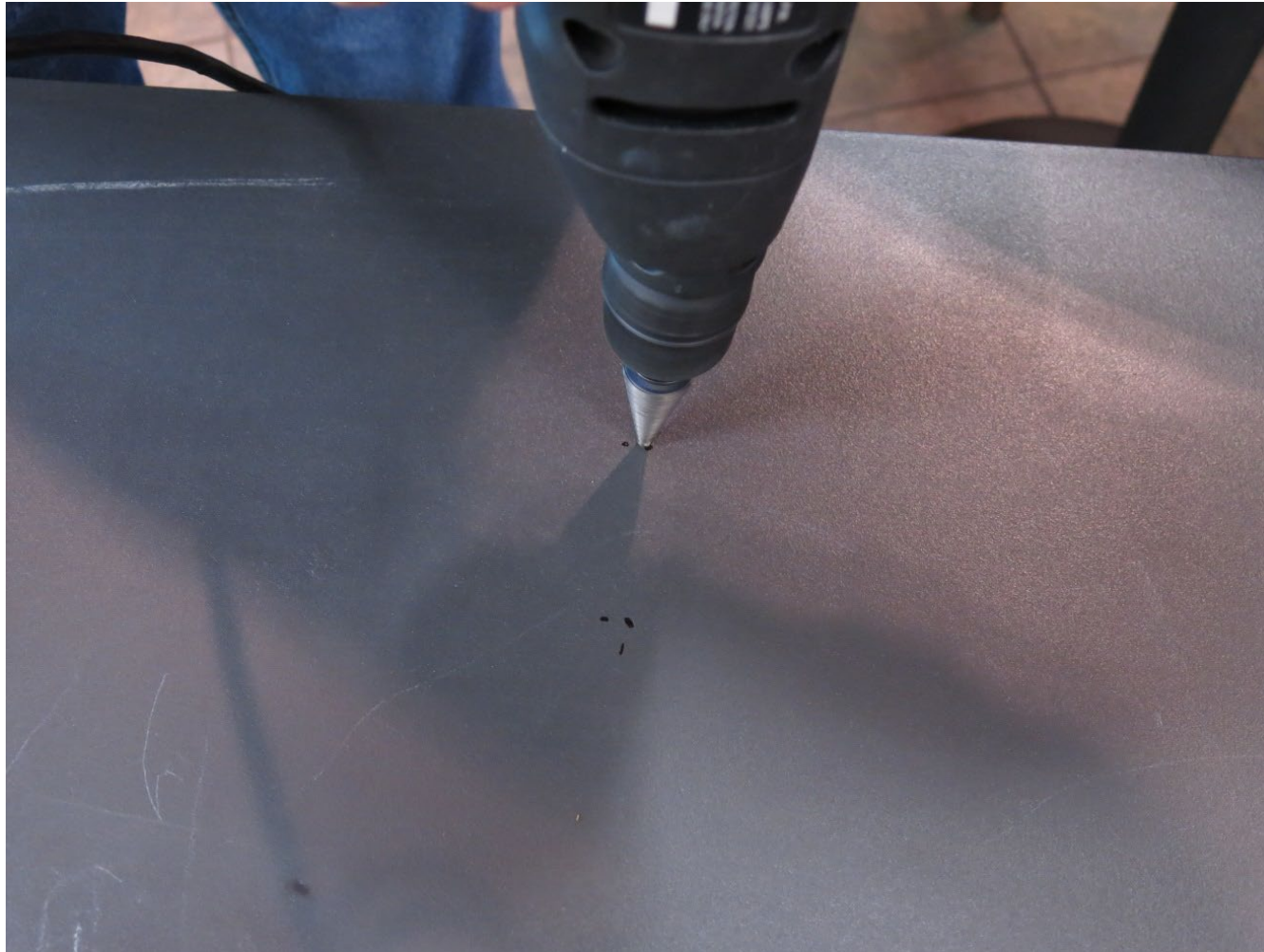

Place the mounting rivets or self drilling screws into the mounting holes.



ICEZONE INSTALLATION

Re-attach the Input/Output cover and secure with the original screw.



Cut two 2.5-inch pieces of tubing to connect the supply and return fittings to the 90-degree hose barbs.

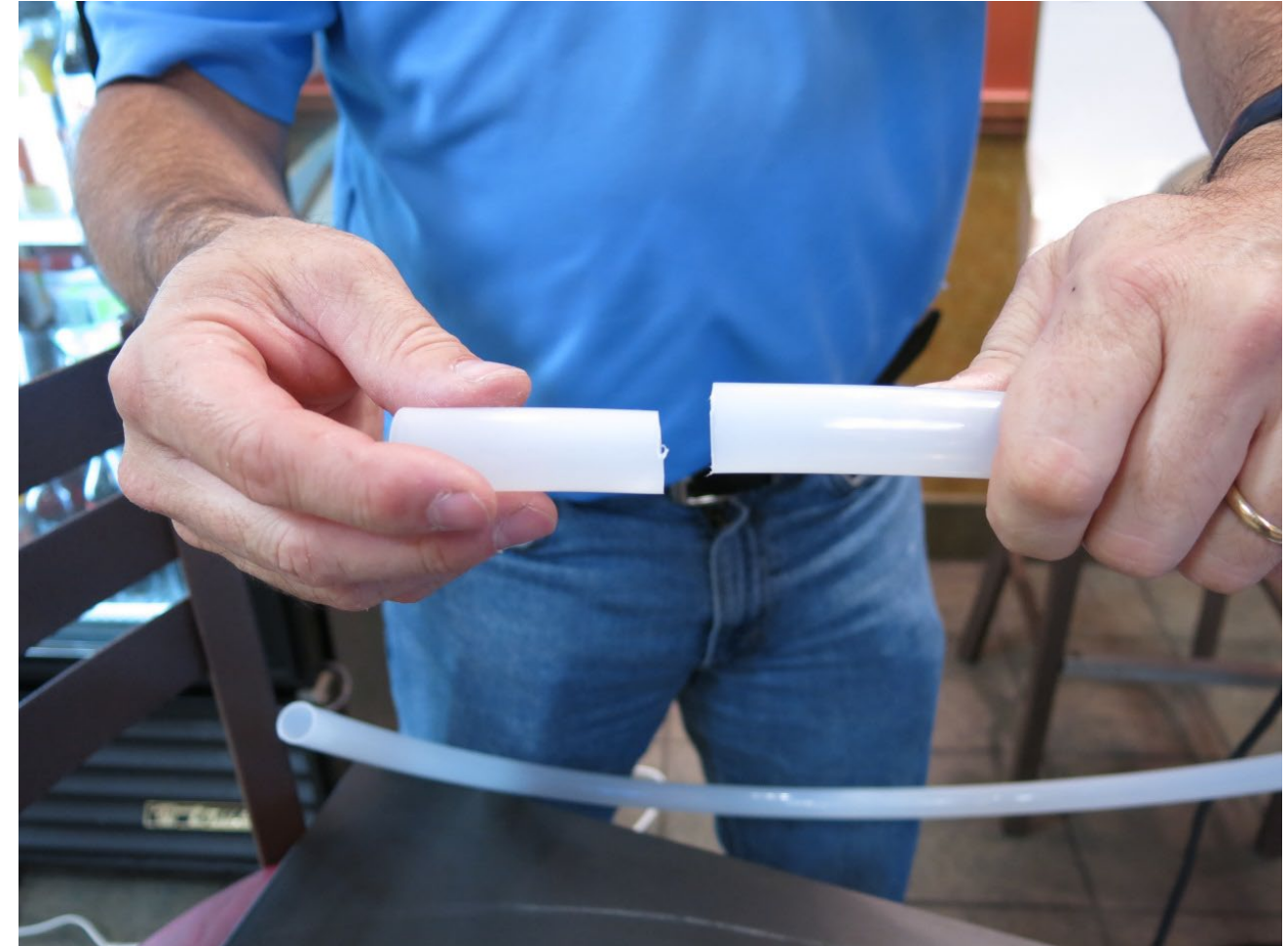

ICEZONE INSTALLATION

Assemble the supply and return fittings to the 90-degree hose barbs using the 2.5-inch pieces of tubing.

Installer's Tip: Heating the tubing in hot water eases the installation of the tubing onto the fittings.



Cut and assemble the remaining supply and return tubing and fittings. There likely will be a quantity of unused tubing, as excess tubing is supplied in the installation kit.

Place the handy clamps (black) on the tubing which is placed over the ports on the Icezone.

Installer's Tip: Heating the tubing in hot water eases the installation of the tubing onto the fittings.



ICEZONE INSTALLATION

Tighten the handy clamps with a pliers to secure the tubing on the Icezone unit.

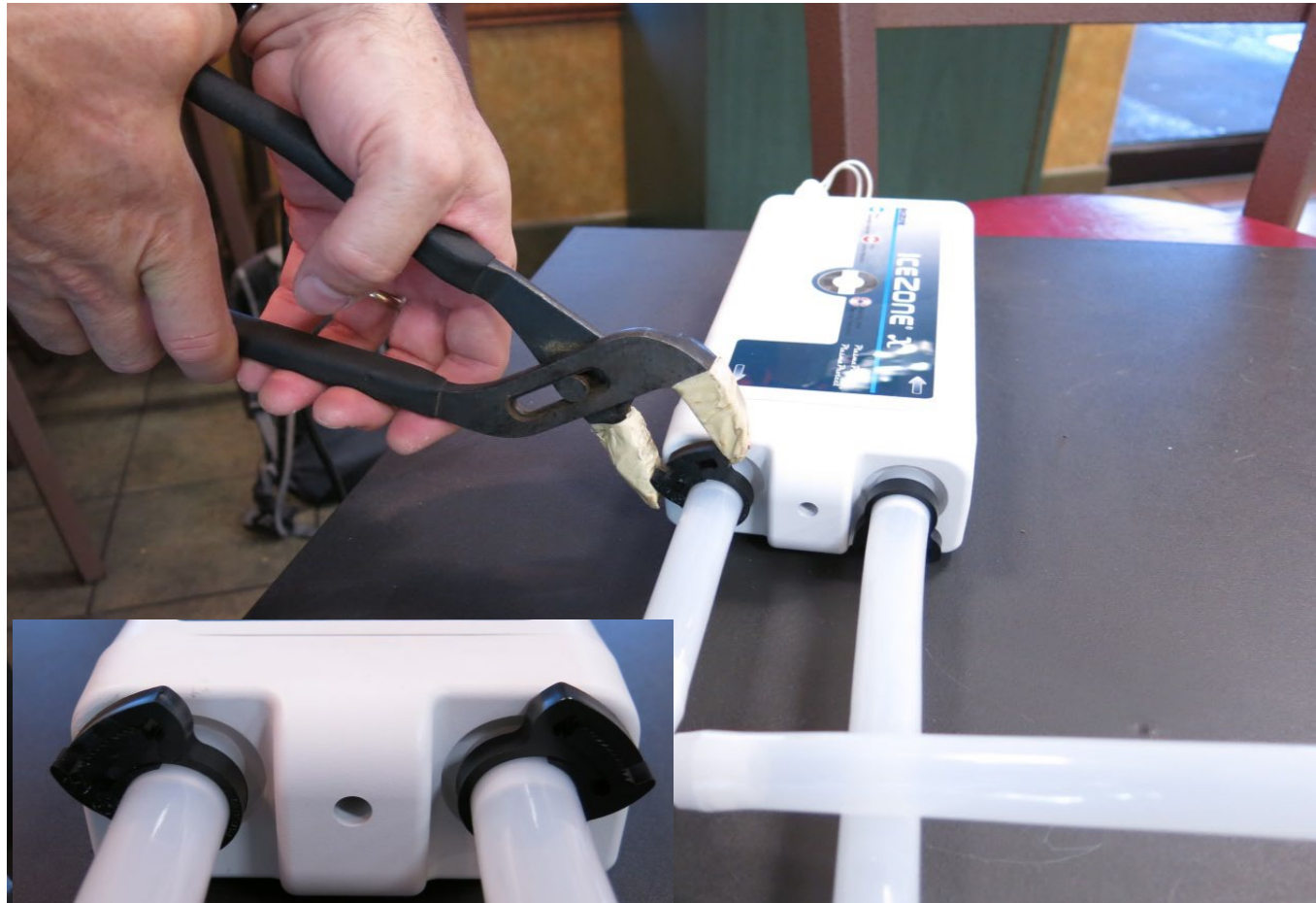

Insert the DC plug from the wall adapter through the "P" shaped hole in the service cover.

Plug the DC connector into the Icezone Unit's power input plug.

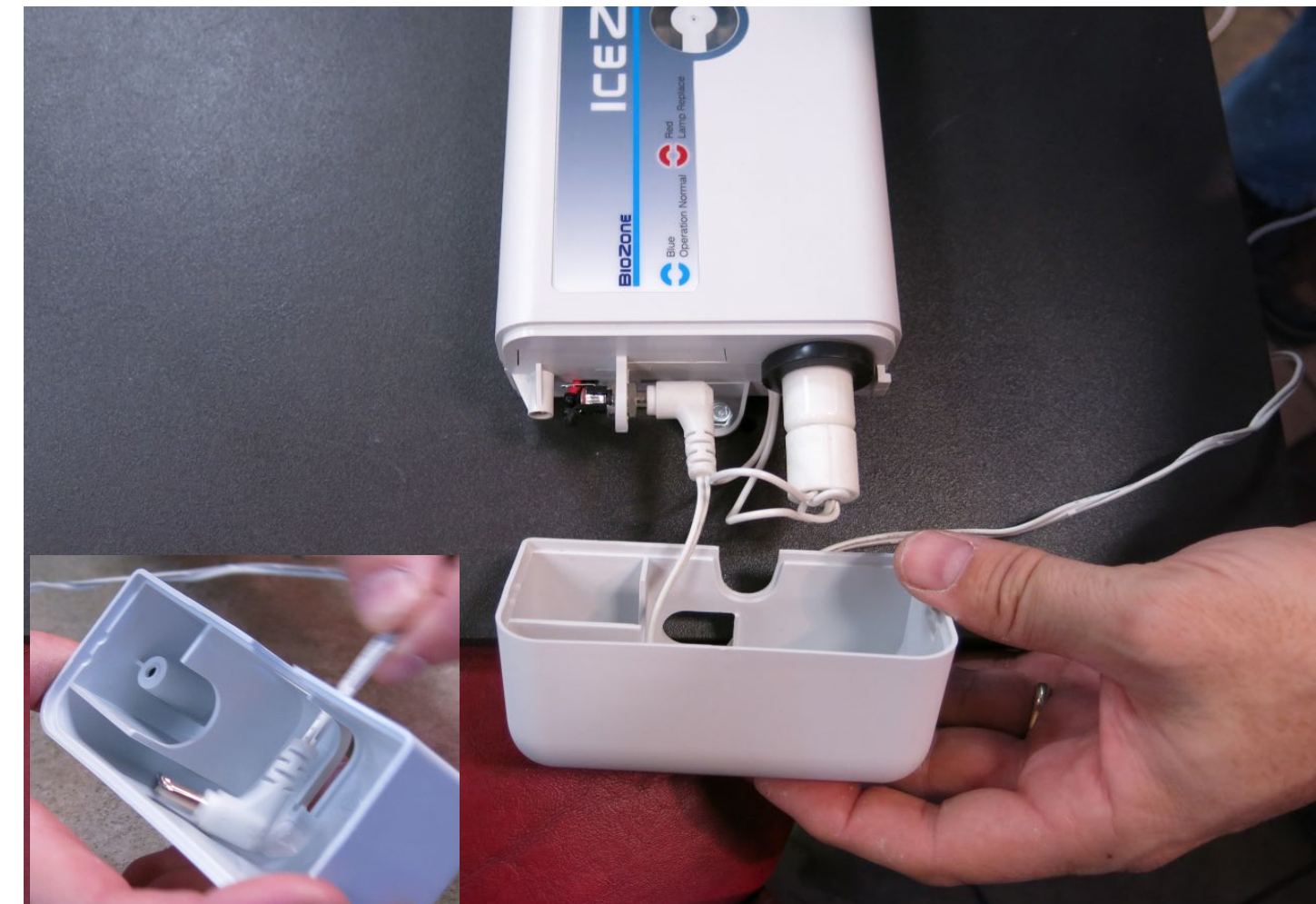

ICEZONE INSTALLATION

Reinstall the service cover and secure with the original screw.



The completed installation on the drink dispenser should look like the picture shown.

The supply fitting is located on the left side of the top panel/cover and the return fitting is located on the right side of the top panel/cover.



ICEZONE INSTALLATION

Sanitize the surfaces of the top panel/cover, turn the machine on, and replace the top panel/cover.

Plug the Icezone into a nearby 120VAC outlet that is not switched off. The Icezone runs 24 hours/day, 7 days per week.

Check to make sure the blue light is lit on the top of the Icezone.

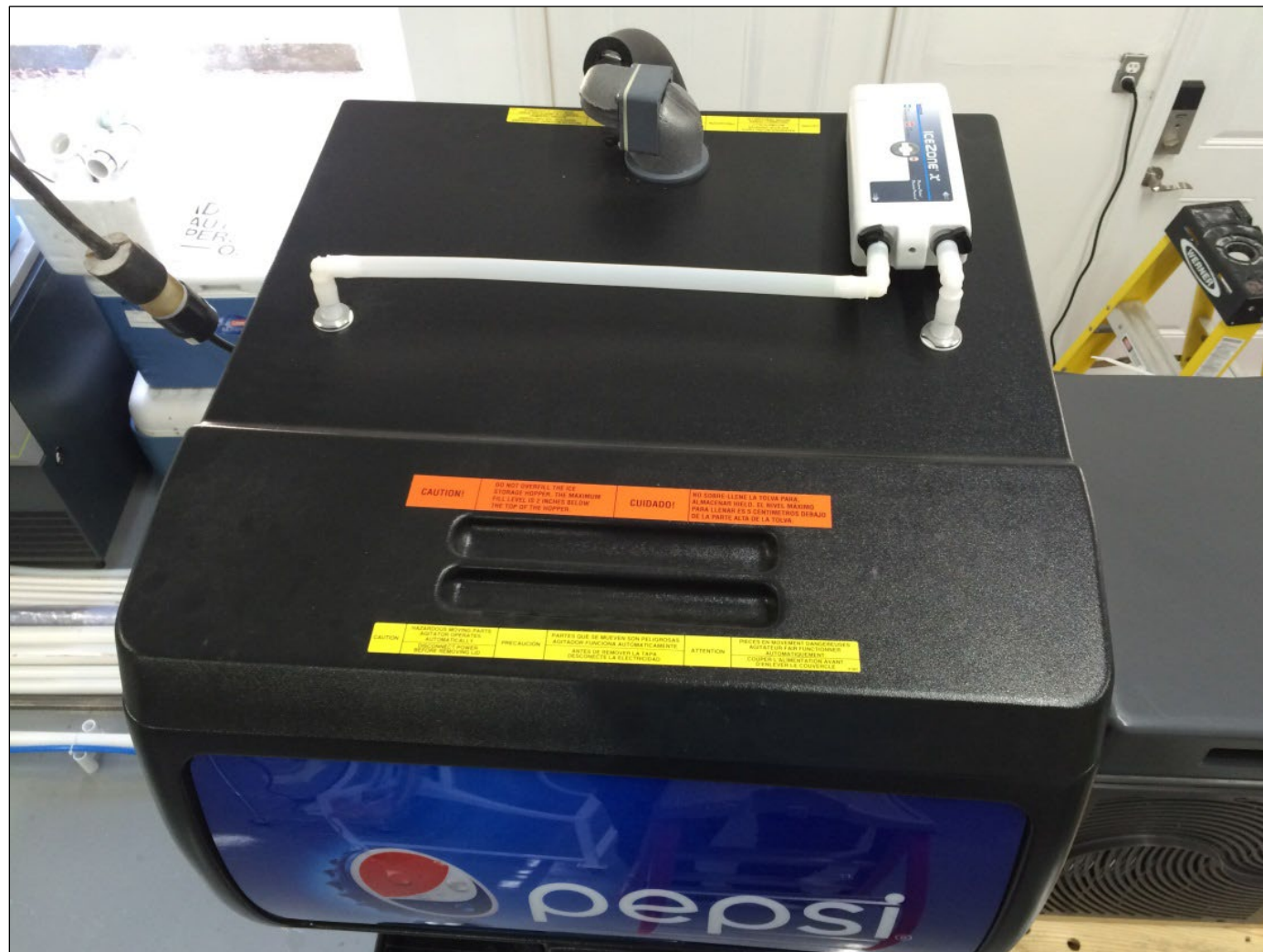

When Icezone is connected to power correctly and the the operation is normal a blue light shows on top of the unit.

When the red light is steady on top of the Icezone, the lamp needs to be changed.

When the red light is flashing on top of the Icezone, the unit requires service.





Thank you for purchasing Icezone

Email: info@bsg-uv.com

Web: biozonescientific.com